

**Career Zoom
Health Care Series**

Session – 4

February 17, 2021



Dr. Amy Watkins
Director of Student Services, Business
Education & Community Education
Wappingers Central School District

Mary Jane Bertram
Regional Director - Hudson Valley
Workforce Development Institute (WDI)

Laraine Kautz
Workforce Development Liaison
Dutchess Community College

Dr. Louise McLoughlin
Executive Director
Dutchess County Workforce Investment Board



Q: What is a Career Zoom Health Care Series?

A: An opportunity to ask questions and learn more about the Health Care profession to see if it might be a good fit for you.



Housekeeping Items

- While the speaker is talking everyone will be on **mute**.
- Have your **camera on** and be visible to the speaker. This is your chance to connect with a professional face-to-face.
- Use the **chat** feature to ask questions.
- Email amy.watkins@wcsdny.org if you have any questions.

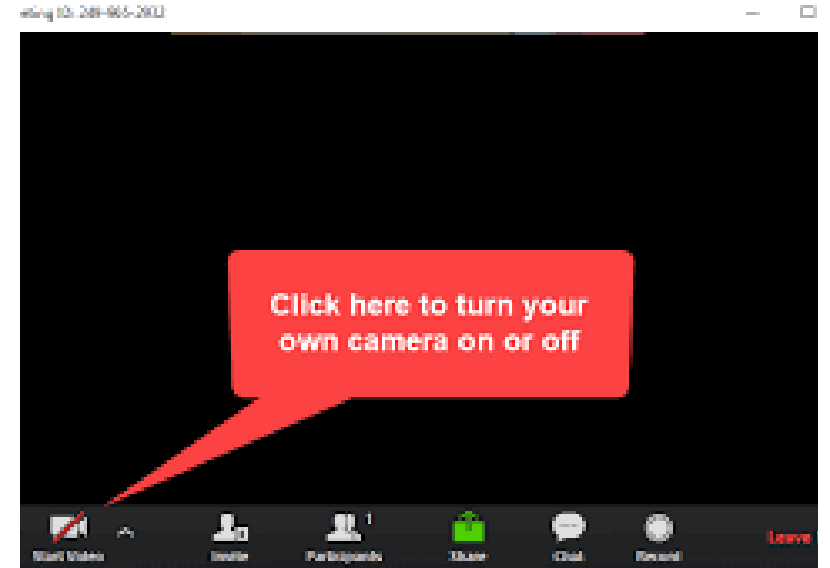

**Today's Career Zoom
Topic:
Specialized Medicine
Pulmonary and Urology**



Medical Doctors

National Salary Average:	\$205,630
NYS Average:	\$186,912
Hudson Valley Salary Average:	\$191,527

Average Hiring Competition Over an Average Supply of Regional Talent

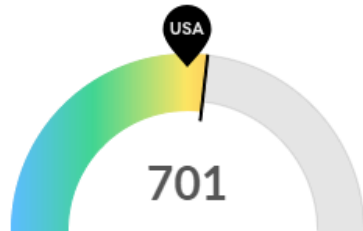

Supply (Jobs)

Your area is about average for this kind of talent. The national average for an area this size is 632* employees, while there are 701 here.

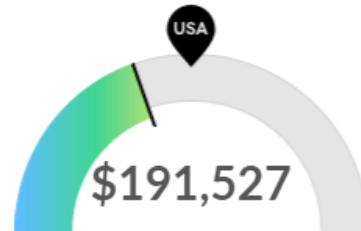

Compensation

The cost for talent is low in your area. The national median salary for Medical Doctors is \$205,630, while you'll pay \$191,527 here.

Job Supply and Compensation in the Hudson Valley



189 Employers Competing

All employers in the region who posted for this job over the last 12 months.

JOB GROWTH PROJECTIONS

- **45% Job Growth from 2015-2020**
- **-1% Expected Job Growth 2020-2025**

Pulmonary Critical Care Physician

National Salary Average:	\$206,286
NYS Average:	\$160,350
Hudson Valley Salary Average:	\$173,990

Average Hiring Competition Over a Deep Supply of Regional Talent

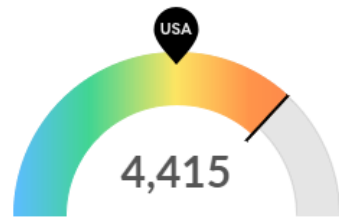

Supply (Jobs)

Your area is a hotspot for this kind of talent. The national average for an area this size is 2,281* employees, while there are 4,415 here.

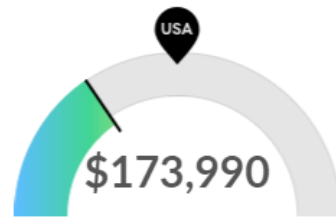

Compensation

The cost for talent is low in your area. The national median salary for Pulmonary Critical Care Physicians is \$206,286, while you'll pay \$173,990 here.

Job Supply and Compensation in the Hudson Valley



199 Employers Competing

All employers in the region who posted for this job over the last 12 months.

JOB GROWTH PROJECTIONS

- **-13% Job Growth from 2015-2020**
- **4% Expected Job Growth 2020-2025**



the Offices of Physicians Industry Sector



Industry

- Offices of Physicians
- General Medical and Surgical H
- Outpatient Care Centers
- Education and Hospitals
- Colleges, Universities, Schools
- Offices of Other H
- Other



Where are the Jobs?

Pulmonary Critical Care Physician

To become a **critical care pulmonologist** requires completion of an **undergraduate and medical degree** before completing both a **residency and fellowship**.

Do I need to go to college?

100%

After graduating from medical school with an MD or DO degree, the physician must complete three years of residency training in internal medicine.



Timothy P. Collins, DO

Dr. Timothy Collins is Division Chief of Pulmonary/Critical Care and Sleep Medicine at Vassar. He is the medical director of the ICU at Vassar Medical Center and is board certified in internal medicine, pulmonary diseases, and critical care medicine. Dr. Collins sees patients with lung disease including asthma and COPD and is the adult Cystic Fibrosis Director for Nuvance Health.





**A CAREER IN NURSING IS MUCH
MORE THAN YOU THINK**



Urology Nurse Practitioners

National Salary Average:	\$109,649
NYS Average:	\$119,311
Hudson Valley Salary Average:	\$129,534

Aggressive Hiring Competition Over a Deep Supply of Regional Talent

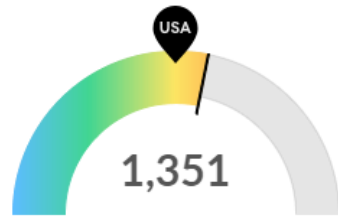

Supply (Jobs)

Your area is a hotspot for this kind of talent. The national average for an area this size is 1,128* employees, while there are 1,351 here.

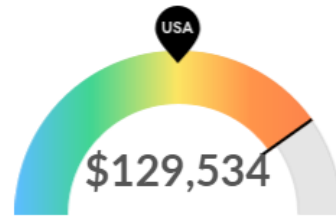

Compensation

The cost for talent is high in your area. The national median salary for Urology Nurse Practitioners is \$109,649, while you'll pay \$129,534 here.

Job Supply and Compensation in the Hudson Valley



194 Employers Competing

All employers in the region who posted for this job over the last 12 months.

JOB GROWTH PROJECTIONS

- **31% Job Growth from 2015-2020**
- **24% Expected Job Growth 2020-2025**

Jobs are Found in the Offices of Physicians Industry Sector

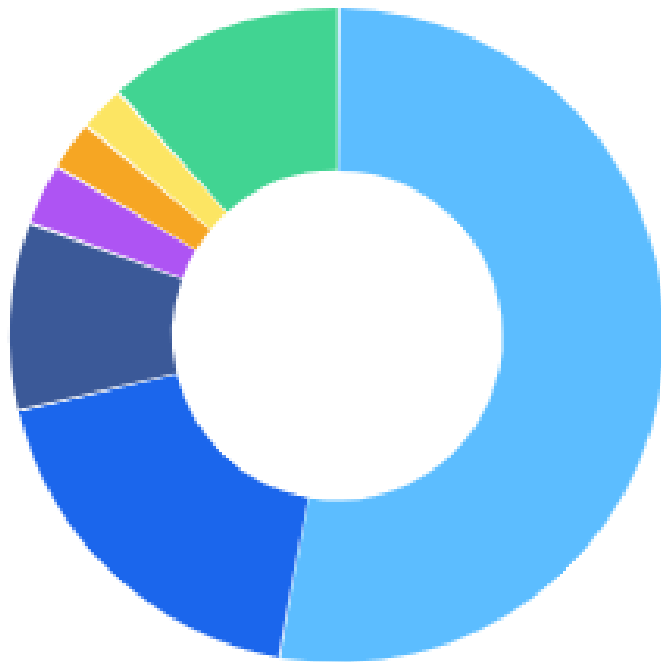

Industry

- Offices of Physicians
- General Medical and Surgical Hospitals
- Outpatient Care Centers
- Offices of Other Health Practitioners
- Education and Hospitals (Local Government)
- Colleges, Universities, and Professional Schools
- Other

Do I need to go to college?

Urology Nurse Practitioners

In order to be a **urology nurse practitioner**, it is necessary to qualify as a **nurse practitioner**. This first involves completing a bachelor's **degree**. The next step is earning a master's **degree** in **nursing** and a **nursing** license. **Urology nurse practitioners** must also acquire practical experience by working in **urology**

National Educational Attainment

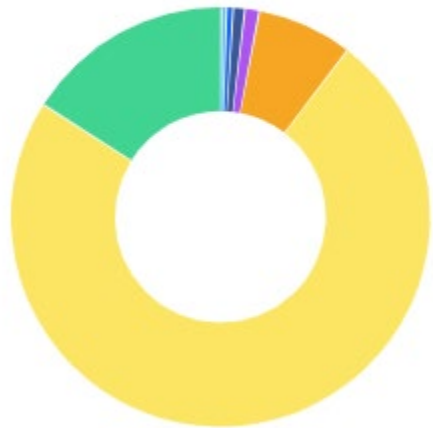

- Less than high school diploma
- High school diploma or equivalent
- Some college, no degree
- Associate's degree
- Bachelor's degree
- Master's degree
- Doctoral or professional degree



Rachel Germano's Career Path



Rachel Germano RN, BSN, CURN
Urology Nursing Supervisor
Premier Medical Urology Division

“I have been a nurse for 10 years now. I always knew that I wanted to be a nurse from a very young age. In order to get a better understanding of medications, I started working at a pharmacy as a Pharmacy Technician. After learning everything possible, I moved to the hospital setting where I was a Unit Secretary, I then became a Nurse’s Aid. During this time, I was going through the nursing program at Dutchess Community College. I graduated with my Associates Degree in 2011. I transitioned from the hospital to a urology office. After 3 years of working as a nurse in the office I was eager to learn more. I started online schooling at Utica College for my BSN. I graduated with my BSN in 2016. I again became interested to learn more, I started my Nurse Practitioner degree at Mount Saint Mary's College. I will graduate with my NP this May and will continue to work in the Urology office”.

-Rachel Germano



DUTCHESS
COMMUNITY COLLEGE



Laraine Kautz
Workforce Development Liaison
Dutchess Community College

DUTCHESS

COMMUNITY COLLEGE



The **150-hour** Dutchess Community College **CNA program** offers convenience and flexibility, with day and evening classes at the Family Partnership Center in downtown Poughkeepsie **and 60 hours of clinical placements at a local nursing home.** Graduates of the program can then take the NYS Department of Health Certification Exam.



The Dutchess Community College graduate **nurse** is educated to become a licensed Registered Professional Nurse who practices within the scope of the New York State Nurse Practice Act and the American Nurses Association Code of Ethics. The Associate in Applied Science (**A.A.S. in Nursing**) is registered by the New York State Education Department

The background of the slide is a collage of three images. The top-left image shows a group of students in white lab coats working in a laboratory. The top-right image shows a group of people, some wearing face masks, in what appears to be a meeting or a classroom. The bottom image shows a woman standing at the front of a classroom, addressing a group of students seated at desks.

SCIENCE (LAX PROGRAM)

Designed for the student who intends to transfer to a four-year institution to earn a baccalaureate degree in a natural or physical science. The program provides a broad background in the liberal arts and sciences. By appropriate selection of courses, a student may build a suitable background for further study in a senior college leading to the baccalaureate degree in biology, chemistry, environmental science and conservation, geology, health education or physics. The Associate in Science (A.S.) degree is awarded upon completion of the requirements for this program.



When to tune in?

- Each month will include guest speakers from Health Care fields. Professionals will share about their experiences and answer the most frequently asked questions collected from the survey.
- There will be time for a Question & Answer at the end of each session.
- Mark your calendar! **Every 3rd Wednesday of the month from 1:00-1:45 PM.**



Thank you!

